

| REV | DATE | ECO | DESCRIPTION | BY | CK | APP |
|-----|---------|-----|--------------|-----|-----|-----|
| - | 6-11-97 | N/A | INIT RELEASE | DBG | N/A | N/A |

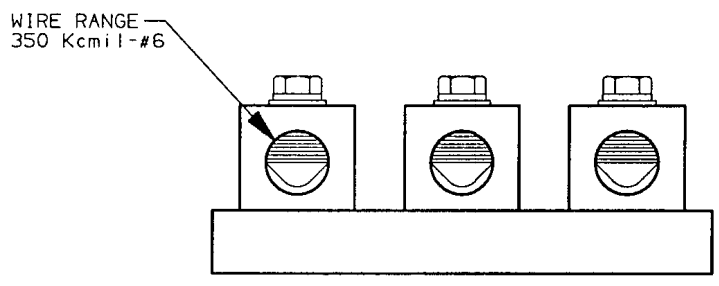
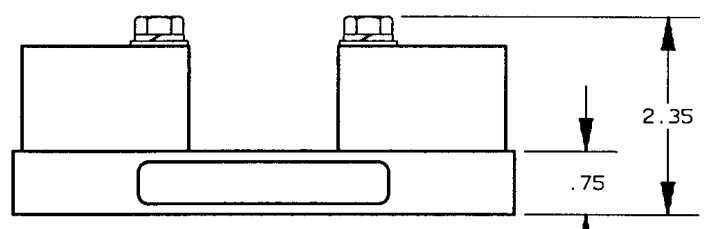
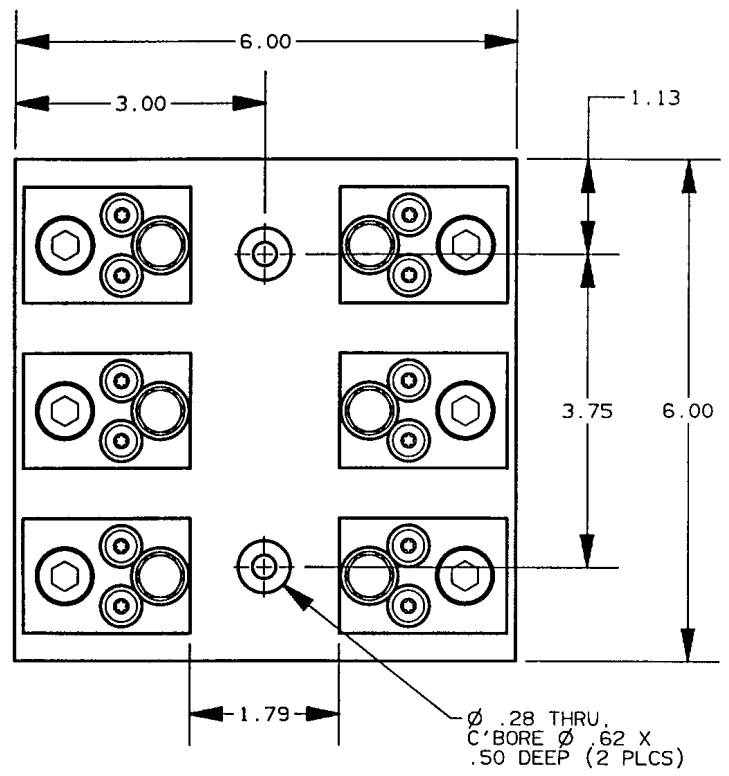

NOTES:

1. UNLESS OTHERWISE SPECIFIED MATERIAL COMPOSITION AND RATING: BASE - THERMOSET 150°C RTI CONNECTOR-ALUMINUM, TIN PLATED.

| P/N | FUSE CLASS | RMS SYM RATING | TORQUE (IN-LBS) | CONNECTOR TYPE | WIRE | | UL | | CSA |
|--------|------------|----------------|-----------------|----------------|------|-------|----------|-----------|------------|
| | | | | | °C | TYPE | FILE NO. | GUIDE NO. | REPORT NO. |
| 62033T | T | 200K | 275 | BOX | 75 | CU-AL | E52283 | IZLT | LR32169 |

GOULD 374 MERRIMAC STREET
NEWBURYPORT, MA 01950

FUSE, BLOCK 600V-200A
CLASS T
3 POLE

OUTLINE DIMENSIONS
NOT TO BE USED FOR PRODUCTION

PRODUCT MANAGER
SIGN: *Nickel 2'ln*
DATE: 6-16-97

DESIGN ENGINEER
SIGN: *Stan M. Benz*
DATE: 6/11/97

700265