

REV.	DATE	ECO	DESCRIPTION	BY	CK	APP
F	1/7/2020	N/A	ADDED CAT NO.'S CNN325 THRU CNN800	GDR	N/A	N/A
G	10/30/2024	18850	REDRAWN FROM CADRA, UPDATED TITLE BLOOCK AND ADDED THICKNESS VIEW	LA	N/A	SEE ECO

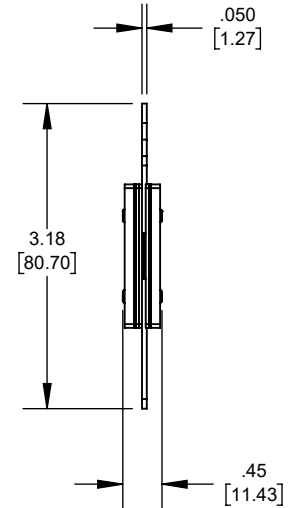
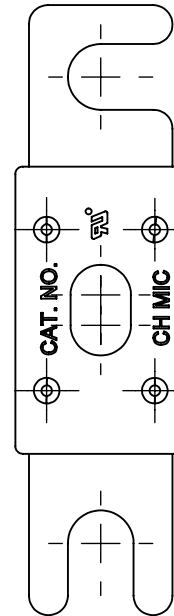
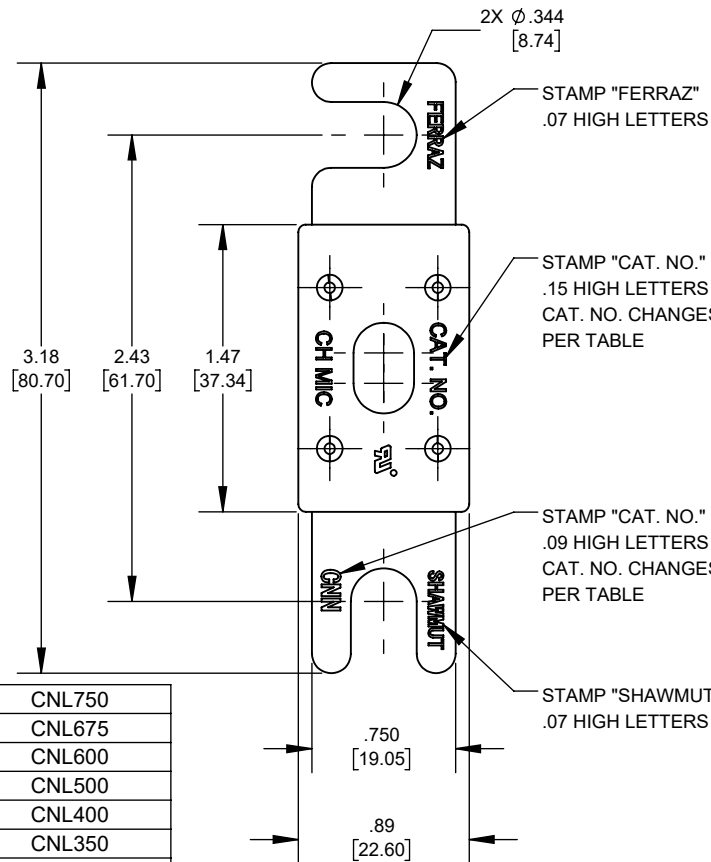

CNN800	
CNN700	
CNN600	CNL750
CNN500	CNL675
CNN400	CNL600
CNN350	CNL500
CNN325	CNL400
CNN300	CNL350
CNN275	CNL325
CNN250	CNL300
CNN225	CNL275
CNN200	CNL250
CNN180	CNL225
CNN175	CNL200
CNN150	CNL175
CNN125	CNL150
CNN100	CNL130
CNN90	CNL125
CNN80	CNL100
CNN60	CNL80
CNN50	CNL60
CNN40	CNL50
CNN35	CNL40
CNN10	CNL35
CATALOG NUMBER	CATALOG NUMBER

OUTLINE DIMENSIONS  
NOT TO BE USED FOR PRODUCTION

DIMENSIONS IN [ ]  
ARE MILLIMETERS

Approval stage / Etat d'approbation: <b>APPROUVÉ POUR FABRICATION / APPROVED FOR MANUFACTURING</b>		Product Class:/ Product Type: <b>FORK LIFT FUSE</b>	
Initial ECO / ECO intiale: <b>ECO-18850-000</b>		Product amp rating:/ Voltage rating: <b>10-800A 80VAC/VDC-130VAC</b>	
Draw by / Dessiné par: <b>Luis ARMENTA</b>	Date : <b>11/5/2024</b>	Title / Titre: <b>OUTLINE</b> CNN(10-800), CNL(35-750)	Weight : Masse :
Checked by / Vérifié par: <b>Yadyra Fang</b>	Date : <b>11/5/2024</b>	Drawing / de dessin: <b>700866</b>	Rev : Rév : <b>G</b>
Electrical Power 374 MERRIMAC STREET NEWBURYPORT, MA 01950	Éch / Scale : <b>1:1</b> Format / Size : <b>A</b>	Part / Article: <b>SEE TABLE</b>	Page : 1/1

Ce plan strictement confidentiel est la propriété exclusive de la société MERSEN sans l'autorisation écrite de laquelle il ne peut être ni reproduit, ni copié, ni communiqué à des tiers.  
This drawing and specifications there on is property of MERSEN and shall not be reproduced or copied or used in whole or in part as the base for manufacture or sale of item without written permission.