

REV.	DATE	ECO	DESCRIPTION	BY	CK	APP
A	2/24/2020	N/A	REDRAWN	GDR	N/A	N/A
B	1/9/2024	18032	UPDATED TITLE BLOCK, ADDED NOTES, DIM .44[11.2] WAS .50[12.7], 1 LBS FORCE WAS 2 LBS FORCE	YF	N/A	SEE ECO

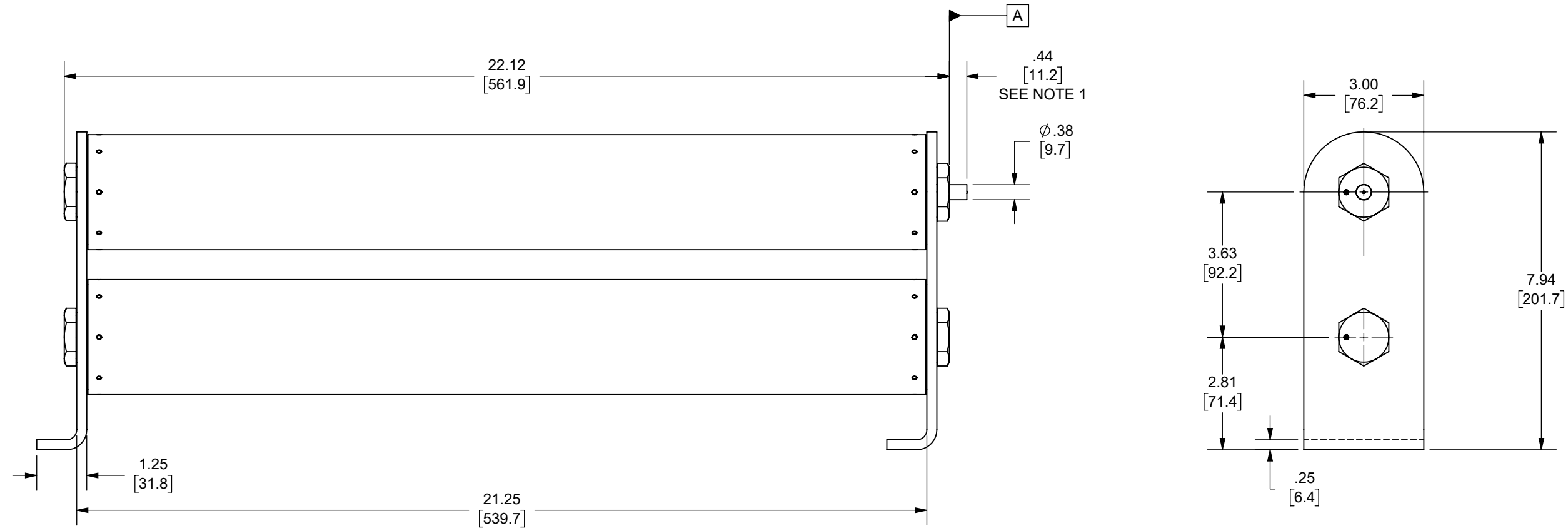

NOTES:

- INDICATOR IS FLUSH WITH SURFACE **A** BEFORE FUSE OPENS
INDICATOR EXTENDS .44 IN. [11.2mm] AFTER FUSE OPENS AND EXERTS
AN 1 LBF AT THE END OF TRAVEL

A055C2D0R0-600E
A055C2D0R0-500E
A055C2D0R0-450E
CATALOG NUMBER

OUTLINE DIMENSIONS
NOT TO BE USED FOR PRODUCTION
DIMENSIONS IN []
ARE MILLIMETERS

Approval stage / Etat d'approbation: APPROUVÉ POUR FABRICATION / APPROVED FOR MANUFACTURING		Product Class:/ Product Type: MEDIUM VOLTAGE CL-14	
Initial ECO / ECO initiale: ECO-18032-000		Product amp rating:/ Voltage rating: 450-600E 5.5kV	
Draw by / Dessiné par: Yadyra Fang	Date : 6/14/2024	Title / Titre: OUTLINE A055C2D0R0-(450-600)E	
Checked by / Vérifié par: Luis ARMENTA	Date : 6/14/2024	Drawing / de dessin: 24405	
Electrical Power 374 MERRIMAC STREET NEWBURYPORT, MA 01950	Éch / Scale : 1:3 Format / Size : B	Part / Article: SEE TABLE	Page : 1/1
MERSEN			
Ce plan strictement confidentiel est la propriété exclusive de la société MERSEN sans l'autorisation écrite de laquelle il ne peut être ni reproduit, ni copié, ni communiqué à des tiers. This drawing and specifications there on is property of MERSEN and shall not be reproduced or copied or used in whole or in part as the base for manufacture or sale of item without written permission.			